

FINAL PROGRAM



2012 Combined Annual Meeting

Chicago Marriott Downtown Chicago, Illinois April 26-27, 2012

CHICAGO

Jointly presented by CSCR, MWAfMR and Institute for the Advancement of Human Behavior (IAHB)

 CSCR
Central Society for Clinical Research



Midwestern Section
American Federation
for Medical Research

www.cscr.com



Central Society for Clinical Research

555 East Wells Street, Suite 1100
Milwaukee, WI 53202-3823
Phone: 414-273-2209 • Fax: 414-276-3349
Email: cscr@execinc.com • Web: www.cscr.com



Midwestern Section American Federation for Medical Research

500 Cummings Center, Suite 4550
Beverly, MA 01915
Phone: 978-927-8330 • Fax: 978-524-8890
Web: www.afmr.org

2012 Combined Annual Meeting of CSCR and MWAfMR

2012 Combined Annual Meeting

Learning Objectives

The 2012 Combined Annual Meeting of the Central Society for Clinical Research (CSCR) and the Midwestern Section American Federation for Medical Research (MWAfMR) presents the Hickam Lecture, Keynote Speaker, two plenary sessions and an oral abstract session on topics of timely interest for researchers and physicians interested in the broad field of clinical research. Participants at the 2012 Combined Annual Meeting will acquire knowledge into clinical research techniques and new findings in various aspects of internal medicine and other fields. At the completion of the meeting, participants should be able to:

- Recognize the value of new research techniques;
- Describe new research findings in cardiology, gastroenterology, pulmonary and critical care, hematology and oncology, nephrology, infectious disease, allergy, immunology and rheumatology;
- Explain the diagnosis and management of diseases and disorders across various subspecialties of medicine.

This activity has been planned and implemented in accordance with the Essential Areas and Policies of the Accreditation Council for Continuing Medical Education through the joint sponsorship of the Institute for the Advancement of Human Behavior (IAHB) and Central Society for Clinical Research and American Federation for Medical Research. [IAHB] is accredited by the ACCME to provide continuing medical education for physicians.

Credit Designation Statement

IAHB designates this live activity for a maximum of *8.25 AMA PRA Category 1 Credit(s)*[™].

Physicians should only claim credit commensurate with the extent of their participation in the activity.



Continuing Medical Education

CME Certificates

In order to obtain your AMA PRA Category 1 Credits™ certificate for this activity, please complete the Credit Verification Form included in your syllabus. Forms should be completed in full and returned to the registration desk at the end of the meeting. Certificates will be mailed 3-4 weeks following the activity to the address provided on your registration form.

Educational Support

This educational activity is supported by unrestricted educational grants from Merck Pharmaceuticals



Faculty/Speaker Disclosure Statement and Disclosure for Discussions of Off Label/Investigational Use of Pharmaceutical Products

In accordance with ACCME Standards for Commercial Support of Continuing Medical Education and the Institute for the Advancement of Human Behavior (IAHB) disclosure policy for CME activities, faculty members have been asked to disclose any relationship they may have with commercial supporters of this CME activity or with companies providing products or medical equipment that may have relevance to the content of their presentations. Such disclosure is intended to provide participants with sufficient information to evaluate whether any given presentation has been influenced by the faculty's relationship(s) or financial interest with said companies.

This activity may include information regarding the off-label and/or investigational use(s) of various pharmacological agents. The faculty have disclosed below if they will be discussing a product which is still investigational or not labeled for the use under discussion.

Speakers, Moderators and Panelists' Disclosure Information

Individual faculty disclosure information can be found on the handout within your registration packet.

2012 Combined Annual Meeting of CSCR and MWAFMR

Hotel Floor Plans

4th Floor

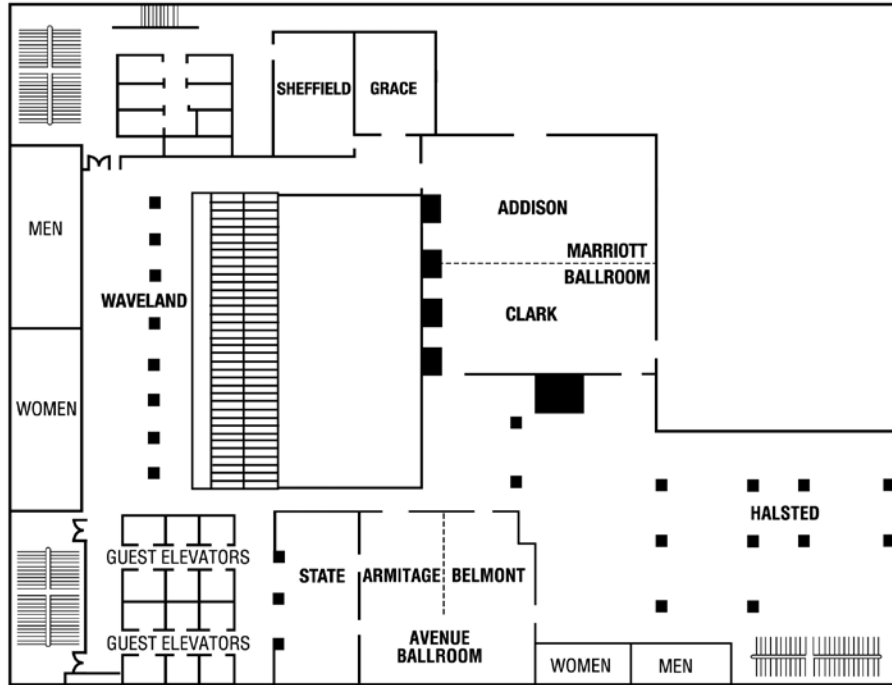

5th Floor

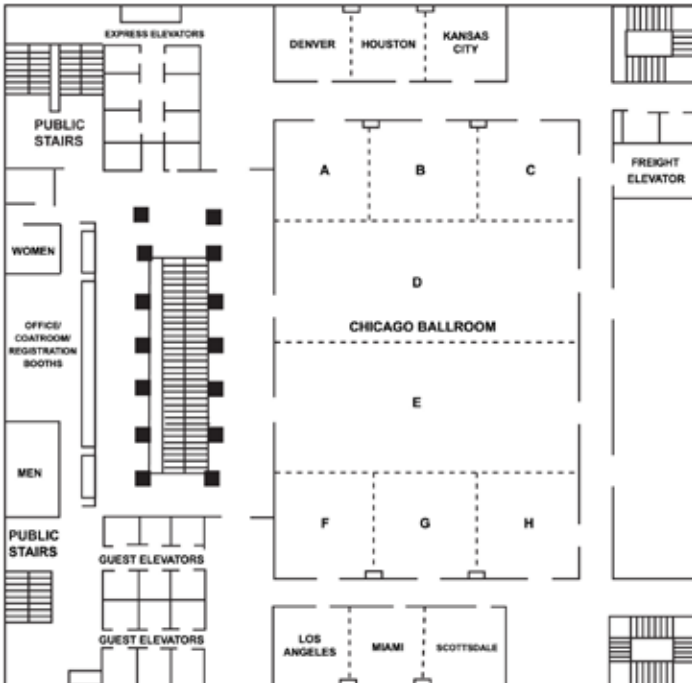

10th Floor

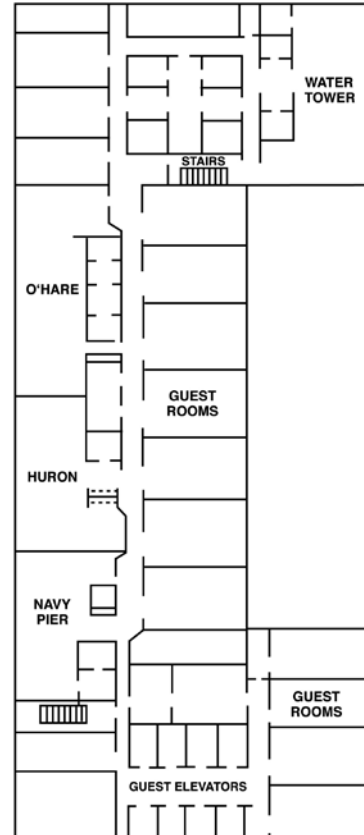

2012 Combined Annual Meeting-At-A-Glance

Chicago Marriott Downtown • Chicago, Illinois • April 26-27, 2012

Thursday, April 26, 2012

12:00pm – 2:00pm	Poster Author Set-Up	Halstead Foyer/Avenue Ballroom
12:00pm – 8:00pm	Registration	State Room
12:00pm – 1:00pm	Editorial Board Luncheon	Grace Room
2:00pm – 4:00pm	CSCR Council Meeting	Sheffield Room
2:00pm – 5:00pm	MWAFMR Career Development Workshop	Denver/Houston Room (5 th floor meeting room)
5:00pm – 7:00pm	Welcome Reception and Poster Session	Halstead Foyer/Avenue Ballroom
7:00pm – 8:30pm	Max Miller Lecture	Clark Room (Marriott Ballroom)
	The Role of Inflammation in Health and Disease	Addison Room (Marriott Ballroom)

Friday, April 27, 2012

7:30am – 3:30pm	Registration	State Room
7:30am – 9:30am	Poster set up	Halstead Foyer/Avenue Ballroom
7:30am – 8:00am	Light Continental Breakfast	Marriott Ballroom Foyer
8:00am – 8:15am	Welcome Remarks & CSCR Annual Business Meeting	
8:15am – 9:30am	MWAFMR Keynote Speaker Nancy J. Brown, MD Vanderbilt University	Marriott Ballroom
9:30am – 10:30am	Poster Session & Morning Break	Halstead Foyer/Avenue Ballroom
10:30am – 11:30am	Department Chair Session I Roy Silverstein, MD <i>presiding</i> Medical College of WI	Addison Room (Marriott Ballroom)
10:30am – 11:30am	Department Chair Session II Everett Vokes, MD <i>presiding</i> University of Chicago Medical Center	Clark Room (Marriott Ballroom)
11:30am – 12:30pm	Poster Session & Lunch	Halstead Foyer/Avenue Ballroom
12:30pm – 1:30pm	CSCR Hickam Lecture Arthur H. Rubenstein, MBCh MBCh University of Pennsylvania	Marriott Ballroom
1:30pm – 2:00pm	Featured New Investigator Lecture R. Stephanie Huang, PhD The University of Chicago	Marriott Ballroom
2:00pm – 3:00pm	Poster Session & Afternoon Break	Halstead Foyer/Avenue Ballroom
3:00pm – 4:00pm	Oral Abstract Session I	Addison Room (Marriott Ballroom)
	Oral Abstract Session II	Clark Room (Marriott Ballroom)
4:00pm – 5:00pm	MWAFMR Scholars Program Reception	Huron Room (10th Floor)

2012 Combined Annual Meeting of CSCR and MWAfMR

2012 Combined Annual Meeting Schedule

All sessions jointly presented by

CENTRAL SOCIETY FOR CLINICAL RESEARCH &
MIDWESTERN SECTION AMERICAN FEDERATION FOR MEDICAL RESEARCH

Thursday, April 27, 2012

12:00pm - 1:00pm Grace Room

CSCR Editorial Board Meeting

2:00pm - 4:00pm Sheffield Room

CSCR Council Meeting

2:00pm - 5:00pm Denver/Houston Room (5th floor)

MWAfMR Career Development Workshop

Abraham Thomas, MD, MPH, *presiding*

Faculty Development: Presentation Skills for Physicians and Scientists Making Your Next Presentation Go Better than Your Last

Scott C. Litin, MD

Professor of Medicine

Mayo Clinic College of Medicine

Division of General Internal Medicine

Department of Internal Medicine

Mayo Clinic

Negotiating a Job Offer

(Presented with an interactive component)

Laurie R. Weingart, PhD

Carnegie Bosch Professor of Organizational Behavior and Theory

Tepper School of Business

Carnegie Mellon University

5:00pm - 7:00pm Halstead Foyer & Avenue Ballroom

Welcome Reception & Poster Session

A complete listing of posters is located at the back of this program.

7:00pm - 8:30pm Addison Room

CSCR Sugar Club/Midwest Metabolism & 52nd Annual Max Miller Lecture in Diabetes Research Nuclear Receptor Regulation of Nutrient Metabolism

David J. Mangelsdorf, PhD

Professor and Chair, Department of Pharmacology

University of Texas Southwestern Medical Center

7:00pm - 8:30pm

Clark Room

The Role of Inflammation in Health and Disease

Inflammation: A Common Pathophysiologic Path for Chronic Disease

Peter Libby, MD, Keynote Presenter

Mallinckrodt Professor of Medicine, Harvard Medical School

Chief, Cardiovascular Medicine, Brigham and Women's Hospital

Featured Presentations by:

Melissa A. Brown, PhD

Professor, Department of Microbiology/Immunology

Northwestern University Feinberg School of Medicine

G.R. Scott Budinger, MD

Associate Professor, Pulmonary and Cell and Molecular Biology

Northwestern University Feinberg School of Medicine

Thomas Gajewski, MD, PhD

Associate Professor, Ben May Department for Cancer Research

The University of Chicago

Friday, April 27, 2012

8:00am - 8:15am

Marriott Ballroom

Welcome Remarks and CSCR Business Meeting

8:15am - 9:30am

Marriott Ballroom

MWAfMR Keynote Presentation

From ACE Inhibitor-Associated Angioedema to Diabetes

Following a Scientific Lead

Nancy J. Brown, MD

Chair, Department of Medicine

Vanderbilt University

9:30am - 10:30am

Halstead Foyer & Avenue Ballroom

Poster Session & Morning Break

A complete listing of posters is located at the back of this program

2012 Combined Annual Meeting Schedule

All sessions jointly presented by

**CENTRAL SOCIETY FOR CLINICAL RESEARCH &
MIDWESTERN SECTION AMERICAN FEDERATION FOR MEDICAL RESEARCH**

10:30am – 11:30am Addison Room	12:30pm – 1:30pm Marriott Ballroom
<p>Department Chair Session I Roy Silverstein, MD, <i>presiding</i> <i>Medical College of Wisconsin</i></p> <p>Phase I Study of the Adenosine 2A Agonist Regadenoson in Sickle Cell Anemia Joshua Field, MD <i>Assistant Professor Hematology/Oncology</i></p> <p>Adverse Effects of Low Glucose on Human Endothelial Function Michael E. Widlansky, MD, MPH <i>Assistant Professor Division of Cardiovascular Medicine</i></p> <p>Using Induced Pluripotent Stem Cells to Study Dystrophic Cardiomyopathy Jennifer L. Strande, MD, PhD <i>Assistant Professor Internal Medicine, Division of Cardiovascular Medicine</i></p>	<p>CSCR Hickam Lecture</p> <p>Academic Leadership: The Legacy of John B. Hickam Arthur H. Rubenstein, MBCh <i>Professor of Medicine, Department of Medicine Endocrinology, Diabetes and Metabolism University of Pennsylvania</i></p> <p>1:30pm – 2:00pm Marriott Ballroom</p> <p>Featured New Investigator Lecture Jeffrey Laurence, MD, <i>presiding</i></p> <p>Microna Processing Genes and Implications for Human Complex Traits R. Stephanie Huang, PhD <i>Assistant Professor of Medicine, Section of Hematology-Oncology, The University of Chicago</i></p> <p>2:00pm – 3:00pm Halstead Foyer/Avenue Ballroom</p> <p>Poster Session & Afternoon Break</p>
10:30am – 11:30am Clark Room	3:00pm – 4:00pm Addison Ballroom
11:30am – 12:30pm Halstead Foyer/Avenue Ballroom	
<p>Department Chair Session II Everett Vokes, MD, <i>presiding</i> <i>University of Chicago Medical Center</i></p> <p>Chicken or Egg? Sleep and Health in Hospitalized Older Patients Vineet Arora, MD, MAPP <i>Associate Professor Internal Medicine</i></p> <p>The Paradox of Progress Environmental Disruption of Metabolism and the Diabetes Epidemic Robert Sargis, MD, PhD <i>Instructor, Section of Adult and Pediatric Endocrinology, Diabetes & Metabolism</i></p> <p>Drugging the Kinome . . . Personally Michael Maitland, MD, PhD <i>Assistant Professor, Section of Hematology/Oncology</i></p>	<p>Oral Abstract Presentation I Jordan Metcalf, MD, <i>presiding</i> <i>(Presentation of award to the Outstanding Young Investigator Recipient)</i></p> <p>Outstanding Young Investigator Award Recipient</p> <p>F-box protein FBXL19 protects against lipopolysaccharide-induced lung inflammation and injury Yutong Zhao, MD, PhD <i>Associate Professor of Medicine, University of Pittsburgh</i></p> <p>Variants in the 3' untranslated region of the KCN01-encoded KV&.1 potassium channel modify disease severity in patients with Type 1 long QT syndrome in an allele-specific manner John Giudicessi, MD, PhD Candidate <i>Mayo Clinic</i></p> <p>Oxalobacter formigenes conditioned medium stimulates oxalate transport by human intestinal cells Hatim Hassan, MD, PhD <i>Assistant Professor of Nephrology, The University of Chicago</i></p>
<p>Poster Session & Lunch</p>	

2012 Combined Annual Meeting of CSCR and MWAFMR

2012 Combined Annual Meeting Schedule

All sessions jointly presented by

CENTRAL SOCIETY FOR CLINICAL RESEARCH &
MIDWESTERN SECTION AMERICAN FEDERATION FOR MEDICAL RESEARCH

3:00pm – 4:00pm

Clark Ballroom

Oral Abstract Presentation II

Neal Weintraub, MD, *presiding*

(Presentation of award to the Cardiovascular Award recipient)

Cardiovascular Award Recipient

Association of biomarker sphingosine-1-phosphate receptor 3 genetic variants with human susceptibility to sepsis-induced acute lung injury

Xiaoguang Sun, MD, PhD

*Institute for Personalized Respiratory Medicine, The Garcia Lab
The University of Illinois at Chicago*

Tarcolimus and sirolimus induce reproductive abnormalities in normal rats

Vijay Shivaswamy, MBBS

*Assistant Professor, University of Nebraska Medical Center
Omaha VA Medical Center*

**Sleep duration and the etiology of depressive symptoms
Evidence for a gene-environment interaction**

Nathaniel Watson, MD

Associate Professor of Neurology, University of Washington



Welcome Reception and Poster Session

Thursday, April 26, 2012 • 5:00pm – 7:00pm • Halstead Foyer/Avenue Ballroom

Cardiology/Cardiovascular Disease

1

VARIANTS IN THE 3' UNTRANSLATED REGION OF THE KCNQ1-ENCODED KV7.1 POTASSIUM CHANNEL MODIFY DISEASE SEVERITY IN PATIENTS WITH TYPE 1 LONG QT SYNDROME IN AN ALLELE-SPECIFIC MANNER

J.R. Giudicessi, M.J. Ackerman, Mayo Clinic, Rochester, MN; A.S. Amin, A.J. Tijssen, Y.M. Pinto, A.A. Wilde, Academic Medical Center, Amsterdam, Netherlands; (Oral Presentation Award Recipient, MWAFFMR Scholars Award)

3

SPHINGOSINE KINASE 1 DEFICIENCY PROTECTS RODENTS FROM CHRONIC HYPOXIA-MEDIATED PULMONARY HYPERTENSION

J. Chen, L. Morenoi-Vinasco, K.M. Shioura, S. Sammani, V. Mohan, L. Huang, S. Pendyala, J.X. Yuan, J.G. Garcia, V. Natarajan, R.F. Machado, University of Illinois at Chicago, Chicago, IL

5

ROLE OF CARDIOTONIC STEROIDS IN PREECLAMPSIA A TRANSLATIONAL APPROACH WITH IN VIVO, IN VITRO, AND PATIENT STUDIES

M.N. Uddin, S.R. Allen, R.O. Jones, T.J. Kuehl, Department of OB/GYN, Texas A & M University College of Medicine/Scott & White, Temple, TX; D. Horvat, D.C. Zawieja, Department of Systems (Trainee Travel Award Recipient)

7

CONDUCTION ABNORMALITIES IN ADULT CARDIOMYOCYTES OVEREXPRESSING MICRORNA-130A

G. Kim, S. McSharry, H. Padden, A. Osbourne, E. Svensson, Medicine, University of Chicago, Chicago, IL (K-Award Recipient)

11

OXIDIZED CA²⁺ AND CALMODULIN-DEPENDENT PROTEIN KINASE II CAUSES SINUS NODE DYSFUNCTION AND INCREASED ACUTE POST-MYOCARDIAL INFARCTION MORTALITY IN DIABETIC MICE

M. Luo, University of Iowa Hospitals & Clinics, Iowa City, IA

13

SUBSTRATE FOR VENTRICULAR ARRHYTHMIA IN MITOCHONDRIAL OXIDATIVE STRESS; C-SRC INHIBITION PREVENTS REDUCTION IN CARDIAC SODIUM CURRENT, AND CONNEXIN43

A.A. Sovari, H. Liu, C.A. Ruutledge, D. Arasu, E. Jeong, M. Liu, N. Vahdani, M.G. Bonini, S.C. Dudley, Medicine/Cardiology, University of Illinois at Chicago, Chicago, IL; E. Dolmatova, A. Tan, H.S. Duffy, Medicine/Cardiology, Beth Israel Deaconess Medical Center, Boston, MA; (Trainee Travel Award Recipient)

15

PREDICTORS OF OCCLUSIVE CORONARY ARTERY DISEASE AMONG PATIENTS WITH COCAINE-ASSOCIATED ACUTE CORONARY SYNDROME

M. Garg, Cardiology, Guthrie Clinic, Sayre, PA; R. Kettlekamp, Cardiology, Saint Lukes Methodist Hospital, Cedar Rapids, IA

2012 Combined Annual Meeting of CSCR and MWAfMR

Welcome Reception and Poster Session

Thursday, April 26, 2012 • 5:00pm – 7:00pm • Halstead Foyer/Avenue Ballroom

Endocrinology/Metabolism

17

TACROLIMUS AND SIROLIMUS INDUCE REPRODUCTIVE ABNORMALITIES IN NORMAL RATS

V. Shivaswamy, R.G. Bennett, F.G. Hamel, J.S. Davis, VA Nebraska Western Iowa Health Care System, Omaha, NE; C.C. Clure, B. Ottemann, C. Wang, J.L. Larsen, University of Nebraska Medical Center, Omaha, NE; (Oral Abstract Award Recipient)

18

THE COST-EFFECTIVENESS OF GENETIC TESTING FOR MATURITY-ONSET DIABETES OF THE YOUNG

R.N. Naylor, S.W. Greeley, L.H. Philipson, G.I. Bell, Endocrinology, University of Chicago, Chicago, IL; P.M. John, E.S. Huang, General Internal Medicine, University of Chicago, Chicago, IL; A.N. Winn, Quantitative Social Sciences, Harvard University, Boston, MA

19

DYNAMIC EVOLUTION OF THYROID TEST ABNORMALITIES IN MCT8 DEFECT

A. Dumitrescu, X. Liao, R. Weiss, S. Refetoff, Medicine, University of Chicago Medical Center, Chicago, IL; (MWAfMR Scholars Award)

21

THE NOVEL ENDOCRINE DISRUPTOR TOLYLFLUANID IMPAIRS ADIPOCYTIC INSULIN SIGNALING THROUGH A REDUCTION IN INSULIN RECEPTOR SUBSTRATE-1 LEVELS

R.M. Sargis, M.J. Brady, Medicine, University of Chicago, Chicago, IL; B.A. Neel, Committee on Molecular Pathogenesis and Molecular Medicine, University of Chicago, Chicago, IL; (K-Award Recipient)

23

TCF19 IS A NOVEL TRANSCRIPTION FACTOR NECESSARY FOR PANCREATIC BETA CELL PROLIFERATION AND SURVIVAL

K.A. Krautkramer, D.A. Fontaine, L.M. Meske, G.J. Schleis, T.W. Harris, J.A. Lavine, D.B. Davis, Medicine/Endocrinology, University of Wisconsin, Madison, WI; (Trainee Travel Award Recipient, K-Award Recipient)

25

MOLECULAR IMPACT OF BARIATRIC SURGERY ON HUMAN ADIPOSE TISSUE

A.A. Koshy, A.M. Bobe, K.A. Temple, M.J. Brady, Department of Medicine, Section of Endocrinology, Diabetes, and Metabolism, University of Chicago Medical Center, Chicago, IL; (Trainee Travel Award Recipient)

27

IMPAIRED IN VIVO SUPPRESSION OF LIPOLYSIS IN POLYCYSTIC OVARY SYNDROME

S.K. Yalamanchi, M.O. Cardenas, A. Dunaif, Division of Endocrinology, Metabolism & Molecular Medicine, Northwestern University, Feinberg School of Medicine, Chicago, IL; S. Sam, Section of Endocrinology, Diabetes, & Metabolism, University of Illinois, Chicago, Chicago, IL; J. Miles, Endocrine Research Unit, Mayo School of Graduate Medical Education, Center for Translational Science Activities, Mayo Clinic, Rochester, MN

28

EXPERIMENTAL SLEEP RESTRICTION REDUCES PHYSICAL ACTIVITY IN ADULTS WITH PARENTAL HISTORY OF TYPE 2 DIABETES

L.E. Bromley, J.N. Booth, L. Alcantar, P.D. Penev, Department of Medicine, University of Chicago, Chicago, IL; J.M. Kilkus, J. Imperial, Clinical Research Center, University of Chicago, Chicago, IL; (Trainee Travel Award Recipient)

29

A ROLE OF A NOVEL NUTRIENT-SENSING GPCR, FFAR2, IN GLUCOSE HOMEOSTASIS DURING PREGNANCY

B. Layden, M. Jorgensen, M. Newman, W.L. Lowe, Medicine, Northwestern University, Chicago, IL; (MWAfMR Scholars Award)

31

NOVEL PATHWAY INVOLVED IN THE DEVELOPMENT OF PAINFUL DIABETIC NEUROPATHY

N. Katz, J.M. Ryals, D.E. Wright, Anatomy and Cell Biology, University of Kansas Medical Center, Kansas City, KS; (MWAfMR Scholars Award)

Welcome Reception and Poster Session

Thursday, April 26, 2012 • 5:00pm – 7:00pm • Halstead Foyer/Avenue Ballroom

33

INCREASES IN NITRIC OXIDE BIOAVAILABILITY FAIL TO IMPROVE VASCULAR COMPLIANCE IN ELDERLY PATIENTS WITH TYPE 2 DIABETES

C. Flynn, R. Kalaitzidis, C. Schaffler, L. Fondren, K. Wroblewski, G. Bakris, The University of Chicago, Chicago, IL; (Trainee Travel Award Recipient)

35

SMRT REGULATES GLUCOCORTICOID ACTION IN ADIPOCYTES

S. Mantis, M. Landeche, X. Han, R. Cohen, Endocrinology, University of Chicago, Chicago, IL

37

EXOME SEQUENCING IN FAMILIES WITH OSTEOPOROSIS OR IDIOPATHIC HYPERCALCIURIA

K.T. Stanley, M.J. Favus, Endocrinology, University of Chicago, Chicago, IL; K. Le, Center for Research Informatics, University of Chicago, Chicago, IL

38

REGULATION OF ADIPOSE TRIGLYCERIDE LIPASE (ATGL) AND GOS2 LIPID DROPLET PROTEINS BY FOXO TRANSCRIPTION FACTORS AND INSULIN IN THE LIVER

W. Zhang, I. O-Sullivan, T.G. Unterman, Medicine, University of Illinois at Chicago and Jesse Brown VAMC, Chicago, IL; S. Bu, D.G. Mashek, Nutrition and Food Science, University of Minnesota, Saint Paul, MN; C. Kahn, Joslin Diabetes Center, Harvard Medical School, Boston, MA

106

MITOCHONDRIAL PROTEIN ACETYLATION AND SIRT3 REGULATE INSULIN SENSITIVITY IN WHITE ADIPOSE TISSUE

M. Hirshet, PhD; Duke University Medical Center, Durham, NC; (Early Career Development Award Recipient)

Epidemiology/Health Care Outcomes/Quality Improvement/Bioinformatics

39

MEDICAL DEVICE APPROVAL SYSTEM IS PMA MORE EFFECTIVE THAN 510(K)? STUDY OF RECALLED MEDICAL DEVICES

P. McEwen, J. Molnar, S. Basu, J.C. Somberg, Medicine and Pharmacology, Rush University, Chicago, IL

41

DO INTERNATIONAL MEDICAL GRADUATES HAVE LOW PATIENT SATISFACTION RATES?

K. Anderson, A. Reeves, F. Qureshi, Mayo Clinic Health System, Mankato, MN; M. Qureshi, Public Administration, Minnesota State University, Mankato, MN

Gastroenterology/Clinical Nutrition

43

IMIPRAMINE BLOCKS ETHANOL-INDUCED ASMASE ACTIVATION, CERAMIDE GENERATION, AND PP2A ACTIVATION, AND AMELIORATES HEPATIC STEATOSIS IN ETHANOL-FED MICE

S. Liangpunsakul, Y. Rahmini, R. Ross, Z. Zhao, Y. Xu, D. Crabb, Indiana University, Indianapolis, IN; (K-Award Recipient)

Genetic & Molecular Medicine

45

SLEEP DURATION AND THE ETIOLOGY OF DEPRESSIVE SYMPTOMS EVIDENCE FOR A GENE-ENVIRONMENT INTERACTION

N. Watson, Neurology, University of Washington, Seattle, WA; K.P. Harden, Psychology, University of Texas, Austin, TX; D. Buchwald, Medicine, University of Washington, Seattle, WA; M.V. Vitiello, Psychiatry and Behavioral Sciences, University of Washington, Seattle, WA; A.I. Pack, Division of Sleep Medicine/Department of Medicine, University of Pennsylvania, Philadelphia, PA; J. Goldberg, Epidemiology, University of Washington, Seattle, WA; (Oral Abstract Award Recipient)

2012 Combined Annual Meeting of CSCR and MWAfMR

Welcome Reception and Poster Session

Thursday, April 26, 2012 • 5:00pm – 7:00pm • Halstead Foyer/Avenue Ballroom

47

MICRORNA PROCESSING GENES AND IMPLICATIONS FOR HUMAN COMPLEX TRAITS

E.R. Gamazon, H. Im, B. LaCroix, D. Ziliak, R. Huang, University of Chicago, Chicago, IL; (Featured New Investigator Award Recipient)

49

DNA METHYLATION CONTRIBUTES TO THE POPULATION VARIATION IN EXPRESSION OF THE PHARMGKB VERY IMPORTANT PHARMACOGENES

W. Mu, W. Zhang, Department of Bioengineering, University of Illinois at Chicago, Chicago, IL; S. Delaney, C. Wing, J. McQuade, E.M. Dolan, University of Chicago, Chicago, IL; (Trainee Travel Award Recipient)

51

NEURODEVELOPMENTAL IMPACT OF CONGENITAL HEART DEFECTS IN DOWN SYNDROME

J. Visootsak, A. Perkins, L. Huddleston, S. Sherman, Human Genetics and Pediatrics, Emory University, Decatur, GA; (K-Award Recipient, Trainee Travel Award Recipient)

Geriatrics

53

EXPLORING THE ROLE OF ACTIVITY DEPENDENT MRNA PROCESSING OF ORB2A IN LONG-TERM MEMORY FORMATION

J. Gill, Physiology, University of Kansas Medical Center, Kansas City, KS; M. Blanchette, K. Si, Stowers Institute for Medical Research, Kansas City, MO; (Trainee Travel Award Recipient, MWAfMR Scholars Award)

Hematology and Oncology

55

DEVELOPMENT OF NATURAL KILLER CELLS FROM HUMAN PLURIPOTENT STEM CELLS IN A FEEDER FREE SYSTEM AMENABLE TO CLINICAL TRANSLATION

D. Knorr, Z. Ni, L. Bendzick, A. Bock, D.S. Kaufman, Hematology/Oncology/Transplant, University of Minnesota, Minneapolis, MN; (Trainee Travel Award Recipient)

57

ROLE OF MUC4 IN LUNG CANCER

A. Ganti, P. Dhangada Majhi, Internal Medicine, VA-NWIHCS, Omaha, NE; I. Lakshmanan, S. Das, M. Ponnuswamy, L. Smith, F. Yu, W. West, S.K. Batra, University of Nebraska Medical Center, Omaha, NE; P. Sharma, Creighton University Medical Center, Omaha, NE; (K-Award Recipient)

59

ASTROCYTE-ELEVATED GENE-1 (AEG-1) IS INDUCED BY HYPOXIA AND GLUCOSE DEPRIVATION AND MODULATES THE GLYCOLYTIC PHENOTYPE IN GLIOBLASTOMA

E. Noch, S. Pina-Oviedo, G. Perez-Liz, L. Del Valle, J. Gordon, K. Khalili, Department of Neuroscience, Center for Neurovirology, Temple University School of Medicine, Philadelphia, PA; M. Bookland, Department of Neurosurgery, Temple University School of Medicine, Philadelphia, PA; (Trainee Travel Award Recipient)

61

AMAUIROSIS FUGAX PATHOETIOLOGIC REVERSIBLE ASSOCIATIONS WITH THROMBOPHILIA IN PATIENTS WITHOUT CAROTID ARTERY ATHEROSCLEROSIS OR ATRIAL SEPTAL DEFECTS

J. Jurantee, G. Boriel, C. Abuchabe, S. Munsif, J. Padda, Internal Medicine, The Jewish Hospital Cincinnati, Cincinnati, OH; C.J. Glueck, Cholesterol Center, The Jewish Hospital, Cincinnati, OH; (Trainee Travel Award Recipient, MWAfMR Scholars Award)

63

CENTRAL RETINAL ARTERY AND VEIN THROMBOSIS REVERSIBLE ASSOCIATIONS WITH THROMBOPHILIA

J. Jurantee, G. Boriel, J. Padda, G. Goyal, P. Shah, Internal Medicine, The Jewish Hospital Cincinnati, Cincinnati, OH; C. Glueck, P. Wang, The Cholesterol Center, The Jewish Hospital, Cincinnati, OH

Welcome Reception and Poster Session

Thursday, April 26, 2012 • 5:00pm – 7:00pm • Halstead Foyer/Avenue Ballroom

65

GH POTENTIATES ESTROGEN-DEPENDENT BREAST CANCER CELL PROLIFERATION IN AN IGF-IR-INDEPENDENT BUT EGFR-DEPENDENT MANNER

D.L. Felice, J. Frasor, Physiology and Biophysics, University of Illinois at Chicago (UIC), Chicago, IL; T.G. Unterman, Medicine, University of Illinois at Chicago (UIC), Chicago, IL; S.M. Swanson, Medicinal Chemistry and Pharmacognosy, University of Illinois at Chicago (UIC), Chicago, IL; (MWAFMR Scholars Award)

67

TARGETED THERAPY INDUCED LEUKEMIA AN UNUSUAL PRESENTATION

S.A. Srouf, M.A. Cherry, S. John, J. Holter, OUHSC, Oklahoma City, OK

107

THE EFFECT OF FRACTIONATED CALF THYMUS HISTONE ON PROTHROMBIN TIME OF HUMAN LEVEL 1 PLASMA

A.S. Brecher, J.R. Catazaro, Chemistry, Bowling Green State University, Bowling Green, OH

Infectious Disease

69

PREVALENCE OF VANCOMYCIN HETERORESISTANCE IN STAPHYLOCOCCUS AUREUS IN A TERTIARY CARE TEACHING HOSPITAL

J. Modi, V. Sundareshan, Infectious Diseases, Internal Medicine, Southern Illinois University School of Medicine, Springfield, IL; N.M. Khardori, Infectious Diseases, Microbiology and Molecular Cell Biology, Eastern Virginia Medical School, Norfolk, VA; (Trainee Travel Award Recipient)

71

INFLUENCE OF DIABETES MELLITUS ON MICROBIOLOGY OF CENTRAL VENOUS CATHETER INFECTION

L. Shahani, C. Noggle, SIU School of Medicine, Springfield, IL; N. Khardori, Eastern Virginia Medical School, Norfolk, VA; (Trainee Travel Award Recipient)

73

IMPACT OF CATHETER TYPE ON MICROBIOLOGY OF CENTRAL VENOUS CATHETER INFECTION

L. Shahani, C. Noggle, SIU School of Medicine, Springfield, IL; N. Khardori, Eastern Virginia Medical School, Norfolk, VA

75

EVALUATING THE ROLES OF CHROMATIN STRUCTURE AND TUP1P IN DETERMINING CANDIDA ALBICANS VIRULENCE USING NEXT-GENERATION DNA SEQUENCING

J.M. Rizzo, M.J. Buck, Biochemistry, SUNY Buffalo, Buffalo, NY

Nephrology

77

OXALOBACTER FORMIGENES CONDITIONED MEDIUM STIMULATES OXALATE TRANSPORT BY HUMAN INTESTINAL CELLS

D. Arvans, M. Musch, E. Chang, H. Hassan, Medicine, The University of Chicago, Chicago, IL; M. Cheng, Medicine/Gastroenterology, The University of Illinois Chicago, Chicago, IL; (Oral Abstract Award Recipient)

Pediatrics

79

ADOLESCENTS ARE AT GREATER RISK FOR COCAINE ADDICTION THAN ADULTS

W. Wong, M.T. Bamman, K.A. Ford, M. Marinelli, Cellular and Molecular Pharmacology, Chicago Medical School / Rosalind Franklin University, North Chicago, IL; J.E. McCutcheon, Psychology, University of Illinois-Chicago, Chicago, IL; (Trainee Travel Award Recipient)

2012 Combined Annual Meeting of CSCR and MWAfMR

Welcome Reception and Poster Session

Thursday, April 26, 2012 • 5:00pm – 7:00pm • Halstead Foyer/Avenue Ballroom

Pulmonary/Critical Care

81

F-BOX PROTEIN FBXL19 PROTECTS AGAINST LIPOPOLYSACCHARIDE-INDUCED LUNG INFLAMMATION AND INJURY

Y. Zhao, J. Wei, R.K. Mialki, T. Coon, B.B. Chen, R. Mallampalli, J. Zhao, Medicine, University of Pittsburgh, Pittsburgh, PA; (Outstanding Young Award Recipient, Trainee Travel Award Recipient, MWAfMR Scholars Award)

83

SIMVASTATIN INCREASES SPHINGOSINE-1-PHOSPHATE RECEPTOR 1 GENE EXPRESSION IN HUMAN LUNG ENDOTHELIUM BY KRUPPEL-LIKE FACTOR 2

X. Sun, W. Chen, B. Mathew, J.G. Garcia, Medicine, The University of Illinois at Chicago, Chicago, IL

85

PATHOLOGIC STRETCH INCREASES LUNG ENDOTHELIAL MICROPARTICLE RELEASE

E. Letsiou, S. Sammani, L. Moreno-Vinasco, S. Jayaraman, W. Zhang, S.M. Dudek, J.G. Garcia, Institute for Personalized Respiratory Medicine, Section of Pulmonary, Critical Care, Sleep, and Allergy, University of Illinois at Chicago, Chicago, IL; (Trainee Travel Award Recipient)

87

MULTIPLE MICRORNAs REGULATE NONMUSCLE MYOSIN LIGHT CHAIN KINASE (NMMLCK) GENE EXPRESSION IN PULMONARY ENDOTHELIUM

D. Adyshev, N. Moldobaeva, V. Elangovan, S.M. Dudek, J.G. Garcia, Institute for Personalized Respiratory Medicine, The University of Illinois at Chicago, Chicago, IL; (Trainee Travel Award Recipient, MWAfMR Scholars Award)

88

TREFOIL FACTOR AUGMENTS ENDOTHELIAL CELL BARRIER FUNCTION AND ATTENUATES MURINE VENTILATOR-INDUCED LUNG INJURY

G. Infusino, S. Sammani, J. Siegler, E. Letsiou, T. Wang, C. Evonoski, S. Dudek, J. Garcia, Pulmonary and Critical Care Medicine, University of Illinois Health System, Chicago, IL; (Trainee Travel Award Recipient)

89

GENOTYPE-PHENOTYPE STUDIES ON THE ROLE OF CD177 IN SEPSIS

M. Palagallo, J. Zabner, J. Klesney-Tait, Pulmonary and Critical Care, University of Iowa Hospitals and Clinics, Iowa City, IA; S. Baruah, K. Keck, B. Hilkin, X. Li, Carver College of Medicine, University of Iowa, Iowa City, IA; L. Ware, Department of Medicine, Vanderbilt University Medical Center, Nashville, TN; (MWAfMR Scholars Award)

91

INTEGRIN BETA4 MEDIATES CYCLIC STRETCH-INDUCED ENDOTHELIAL CELL INFLAMMATORY RESPONSES

W. Chen, R.K. Sharma, T. Zhou, K. Reyes, J.G. Garcia, J. Jacobson, Medicine, University of Illinois at Chicago, Chicago, IL; (Trainee Travel Award Recipient)

93

THE INCREASE IN PULMONARY ENDOTHELIAL PERMEABILITY INDUCED BY GROUP V PHOSPHOLIPASE A2 (GVPLA2) DOES NOT REQUIRE MEMBRANE HYDROLYSIS PRODUCTS OR DOWNSTREAM INTRACELLULAR SIGNALING

T. Zhou, S. Dudek, Institute for Personalized Respiratory Medicine, The University of Illinois at Chicago, Chicago IL; Meliton, A. Meliton, A. Leff, Pulmonary & Critical Care Medicine, University of Chicago, Chicago, IL; M. Muñoz, Philippine Foundation for Lung Health, Research and Development, Quezon City, Philippines; (Trainee Travel Awards, MWAfMR Scholars Award)

95

CYCLIC STRETCH INDUCES TYPE 2 DEIODINASE EXPRESSION IN LUNG ENDOTHELIAL CELLS

L. Xie, X. Sun, S. Saad, E. Letsiou, M. Liliana, J.R. Jacobson, S.M. Dudek, J. Garcia, The University of Illinois at Chicago, Chicago, IL; (Trainee Travel Award Recipient)

Welcome Reception and Poster Session

Thursday, April 26, 2012 • 5:00pm – 7:00pm • Halstead Foyer/Avenue Ballroom

97

TYROSINE PHOSPHORYLATION OF PAXILLIN REGULATES LPS-INDUCED REACTIVE OXYGEN SPECIES GENERATION AND ENDOTHELIAL BARRIER DYSFUNCTION

P. Fu, P. Usatyuk, D. He, S. Dudek, M. Brown, J.G. Garcia, V. Natarajan, University of Illinois at Chicago, Chicago, IL; R. Salgia, The University of Chicago, Chicago, IL; (Trainee Travel Award Recipient)

99

PULMONARY HYPERTENSION IN MICE AS A CONSEQUENCE OF INFARCTION-INDUCED CARDIAC DYSFUNCTION

K.M. Shioura, L. Moreno-Vinasco, T. Wang, R. Machado, J. Garcia, Medicine/Section of Pulmonary, Critical Care, Sleep and Allergy, The University of Illinois at Chicago, Chicago, IL

101

TUMSTATIN, A FRAGMENT OF COLLAGEN IV, ATTENUATES THROMBIN-INDUCED FAK PHOSPHORYLATION AND ENDOTHELIAL BARRIER DISRUPTION

T. Zhou, W. Chen, J. Garcia, J. Jacobson, Medicine, UIC, Chicago, IL

Rheumatology/Immunology/Allergy

103

TYPE I AND TYPE II TGF BETA RECEPTORS ARE PRESENT WITHIN THE NUCLEI OF HUMAN AIRWAY EPITHELIAL CELLS

R. Espinosa, E. Karrar, A. Ismail, A. Mosley-Brown, X. Li, K. Serban, B. Camoretti-Mercado, The University of Chicago, Chicago, IL; (K-Award Recipient)

105

THE ROLE OF FACTOR V LEIDEN MUTATION IN OSTEONECROSIS OF THE HIP.

G. Borie, C. Glueck, R.A. Freiberg, J. Jurantee, C. Abuchaibe, Z. Khan, A. Brar, J. Padda, P. Wang, Internal Medicine, The Jewish Hospital of Cincinnati, Cincinnati, OH

2012 Combined Annual Meeting of CSCR and MWAfMR

Morning Break, Lunch, Afternoon Break and Poster Session

Friday, April 27, 2012 • 9:30am – 10:30am • 11:30am – 12:30pm • 2:00pm – 3:00pm • Halstead Foyer/Avenue Ballroom

Cardiology/Cardiovascular Disease

2

INHIBITION OF PRE-B CELL COLONY-ENHANCING FACTOR (PBEF) PREVENTS AND REVERSES MONOCROTALINE-INDUCED PULMONARY HYPERTENSION

J. Chen, H. Yamamura, K.M. Shioura, J. Torres, A. Yamamura, S. Sahni, J. Wan, Q. Guo, S.M. Camp, C. Evenoski, Y. Zhao, A. Desai, L. Moreno-Vinasco, J.X. Yuan, J.G. Garcia, R.F. Machado, University of Illinois at Chicago, Chicago, IL; (Trainee Travel Award Recipient)

4

IMPACT OF PRE-IMPLANT PSYCHIATRIC DIAGNOSIS ON MORTALITY IN PATIENTS WITH AN IMPLANTABLE CARDIOVERTER-DEFIBRILLATOR

R. Smith, L. Simbartl, F. Rothenberg, Cincinnati Veteran's Administration Center, Cincinnati, OH

6

NOX1 NADPH OXIDASE IS NECESSARY FOR LATE, BUT NOT EARLY, ISCHEMIC PRECONDITIONING AGAINST MYOCARDIAL INFARCTION IN MICE

S. Jiang, F. Miller, Internal Medicine, University of Iowa, Iowa City, IA; (Trainee Travel Award Recipient)

8

SERUM 2-METHOXYESTRADIOL, AN ESTROGEN METABOLITE, IS POSITIVELY ASSOCIATED WITH SERUM HDL IN A POPULATION-BASED SAMPLE

C.M. Masi, Medicine, University of Chicago, Chicago, IL; L.C. Hawkey, J.T. Cacioppo, Psychology, University of Chicago, Chicago, IL (K-Award Recipient)

9

POSTURAL ORTHOSTATIC TACHYCARDIA SYNDROME PATTERNS OF BLOOD PRESSURE & HEART RATE RESPONSE TO TILT TEST IN RELATION TO ANXIETY SYMPTOMS

T.J. Rosenberger, L. Saju, F. Fouad-Tarazi, Center for Syncope and Autonomic Disorders, Cleveland Clinic, Cleveland, OH; S. Wedes, Psychiatry, University of Pittsburgh, Pittsburgh, PA; L. Zhu, L. Pozuelo, K. Franco, Psychiatry, Cleveland Clinic, Cleveland, OH; J. Zhang, Psychiatry, Zucker Hillside Hospital, Glen Oaks, NY

10

EPIDEMIOLOGY OF ORTHOSTATIC SYNDROMES IN SYNCOPE PATIENTS

J.E. Smith, L. Saju, F. Fouad-Tarazi, Center for Syncope and Autonomic Disorders, Cleveland Clinic, Cleveland, OH; J. Bena, Quantitative Health Sciences, Cleveland Clinic, Cleveland, OH

12

CAMKII IN THE TRANSITION FROM PRESSURE-OVERLOAD CARDIAC HYPERTROPHY TOWARDS HEART FAILURE IN THE MOUSE

A.G. Rokita, A.E. Mark, Internal Medicine, University of Iowa Carver College of Medicine, Iowa City, IA; K. Schmidt, T. Sowa, L.S. Maier, Cardiology and Pneumology, University of Goettingen, Goettingen, GERMANY; N. Teucher, Cardiothoracic Surgery, University of Goettingen, Goettingen, Germany

14

A NEW COMPUTER BASED METHOD USING BIPOLAR ELECTROGRAM CHANGES TO DETECT MYOCARDIAL ISCHEMIA

P. Mackie, S. Mickelsen, A. Chaudhary, J.B. Martins, Internal Medicine, University of Iowa Hospitals and Clinics, Iowa City, IA; (Trainee Travel Award Recipient)

16

THE DISTRIBUTION OF BLOOD PRESSURE IN RESPONSE TO QUANTITATIVE TILT TESTING IN POTS PATIENTS

J.E. Smith, L. Saju, F. Fouad-Tarazi, Center for Syncope and Autonomic Disorders, Cleveland Clinic, Cleveland, OH; L. Zhu, L. Pozuelo, K. Franco, Psychiatry, Cleveland Clinic, Cleveland, OH; S. Wedes, Psychiatry, University of Pittsburgh, Pittsburgh, PA; J. Zhang, Psychiatry, Zucker Hillside Hospital, Glen Oaks, NY

Morning Break, Lunch, Afternoon Break and Poster Session

Friday, April 27, 2012 • 9:30am – 10:30am • 11:30am – 12:30pm • 2:00pm – 3:00pm • Halstead Foyer/Avenue Ballroom

Endocrinology/Metabolism

20

PREVENTION OF PREGNANCY LOSS AND PREGNANCY OUTCOMES IN WOMEN WITH POLYCYSTIC OVARY SYNDROME AND FAMILIAL THROMBOPHILIA BY GLUCOPHAGE AND ENOXAPARIN

C. Abuchaibe, Z. Khan, N. Goldenberg, C. Glueck, J. Pranicoff, P. Wang, X. Deng, J. Padda, M. Riaz, G. Boriel, J. Jurantee, Internal Medicine, The Jewish Hospital of Cincinnati, Cincinnati, OH

22

PREVENTION OF PREGNANCY LOSS, AND PREGNANCY OUTCOMES IN WOMEN WITH POLYCYSTIC OVARY SYNDROME AND FAMILIAL THROMBOPHILIA BY GLUCOPHAGE, AND ENOXAPARIN

C. Glueck, J. Pranicoff, J. Paada, Z. Khan, A. Brar, G. Goyal, P. Wang, Cholesterol Center, Jewish Hospital, Cincinnati, OH; X. Deng, C. Abuchaibe, G. Boreil, Internal Medicine, Jewish Hospital, Cincinnati OH, Cincinnati, OH

24

USE OF RISEDRONATE FOR PREVENTION OF BONE LOSS AFTER LUNG TRANSPLANTATION

A. Barnosky, C. Alex, P. Camacho, Endocrinology, Loyola University Medical Center, Maywood, IL

26

DETERMINANTS OF APOB, APOA1, AND THE APOB/APOA1 RATIO IN HEALTHY SCHOOLGIRLS, PROSPECTIVELY STUDIED FROM MEAN AGES 10 TO 19 YEARS THE CINCINNATI NATIONAL GROWTH AND HEALTH STUDY

C. Abuchaibe, C. Glueck, G. Boriel, J. Jurantee, X. Deng, P. Wang, Internal Medicine, The Jewish Hospital of Cincinnati, Cincinnati, OH; J. Morrison, Pediatrics, Cincinnati's Children's Hospital, Cincinnati, OH; S. Daniels, Pediatrics, Denver Children's Hospital, Denver, CO; (Trainee Travel Award Recipient)

30

INSULIN RESISTANCE IN THE PERIPHERAL NERVOUS SYSTEM OF TYPE 2 DIABETIC MICE

C.W. Grote, A.L. Groover, J.M. Ryals, D.E. Wright, Anatomy and Cell Biology, University of Kansas Medical Center, Kansas City, KS; P.C. Geiger, Molecular and Integrative Physiology, University of Kansas Medical Center, Kansas City, KS; (Trainee Travel Award Recipient)

32

THROMBOTIC EVENTS AFTER STARTING EXOGENOUS TESTOSTERONE OR ARIMIDEX IN MEN WITH PREVIOUSLY UNDIAGNOSED FAMILIAL THROMBOPHILIA

C.J. Glueck, N. Goldenberg, A. Brar, Z. Khan, P. Wang, Cholesterol and Metabolism Center, The Jewish Hospital, Cincinnati, OH; R. Syed, G. Boriel, X. Deng, Internal Medicine Residency Program, The Jewish Hospital, Cincinnati, OH; (Trainee Travel Award Recipient)

34

TITRATING LOVAZA FROM 4 TO 8 TO 12 GRAMS/DAY IN PATIENTS WITH FAMILIAL HYPERTRIGLYCERIDEMIA WHO HAD TRIGLYCERIDE LEVELS >500 MG/DL DESPITE MAXIMAL TRIGLYCERIDE LOWERING THERAPY.

N.A. Khan, K. Riaz, C.J. Glueck, Z. Khan, P. Wang, Internal Medicine, Jewish Hospital, Cincinnati, OH; (Trainee Travel Award Recipient)

36

PATIENT CHARACTERISTICS AND PARTICIPATION IN GENETICS STUDIES A TYPE 2 DIABETES COHORT

L. Amiri, A. Thomas, Endocrinology, Diabetes, Bone and Mineral Disorders, Henry Ford Health System, Detroit, MI; A.E. Cassidy-Bushrow, H. Dakki, J. Li, K. Wells, Public Health Sciences, Henry Ford Health System, Detroit, MI; D. Lanfear, Heart and Vascular Institute, Henry Ford Health System, Detroit, MI; S.A. Oliveria, S. Phillips, M. Ulcickas Yood, EpiSource, Newton, MA

2012 Combined Annual Meeting of CSCR and MWAfMR

Morning Break, Lunch, Afternoon Break and Poster Session

Friday, April 27, 2012 • 9:30am – 10:30am • 11:30am – 12:30pm • 2:00pm – 3:00pm • Halstead Foyer/Avenue Ballroom

Epidemiology/Health Care Outcomes/Quality Improvement/Bioinformatics

40

CONTINUED COCAINE USE AND RE ADMISSION IN PATIENTS WITH COCAINE-RELATED ACUTE CORONARY SYNDROME

M. Garg, Cardiology, Guthrie Clinic, Sayre, PA; R.T. Kettelkamp, Cardiology, Saint Luke's Methodist Hospital, Cedar Rapids, IA

42

CHICAGO INEQUITIES IN GEOGRAPHICAL ACCESS TO HEALTH CARE

S. Syed, D. Barrett, L. Sharp, A. Jentleson, H. Pauls, University of Illinois at Chicago, Chicago, IL

Gastroenterology/Clinical Nutrition

44

SAFETY OF ENALAPRIL AFTER ABDOMINAL IRRADIATION

M.F. Otterson, S.C. Leming, J. Callison, Surgery, Medical College of Wisconsin, Milwaukee, WI; J.E. Moulder, B.L. Fish, Radiation Oncology, Medical College of Wisconsin, Milwaukee, WI; E.P. Cohen, Medicine, Medical College of Wisconsin, Milwaukee, WI

Genetic & Molecular Medicine

46

POLYMORPHISMS OF THE INTERLEUKIN 6 GENE ARE ASSOCIATED WITH SUSCEPTIBILITY TO SEVERE SEPSIS AND ACUTE LUNG INJURY

B. Mapes, M. Wade, W. Zhang, J. Garcia, Pulmonary, Critical Care, Sleep and Allergy, Institute for Personalized Respiratory Medicine, University of Illinois Hospital and Health Sciences System, Chicago, IL; D. Turner-Lloveras, S. Ma, Pulmonary, Sleep and Critical Care Medicine, The University of Chicago, Chicago, IL

48

IMPAIRED MICROTUBULAR TRANSPORT IN TAUOPATHY LEADING TO AUTOPHAGY GRIDLOCK

Z. Ding, S. Carlton, Neuroscience and Cell Biology, UTMB, Galveston, TX; M.F. Bakhoun, G.R. Jackson, The Mitchell Center for Neurodegenerative Diseases, UTMB, Galveston, TX; (Trainee Travel Award Recipient)

50

PATIENTS WITH FLT3 NEGATIVE ACUTE MYELOID LEUKEMIA AND NORMAL CYTOGENETIC WHO HAVE THE COMBINATION MUTATIONS (NPM1-/CEBPA-) HAVE BETTER SURVIVAL THAN PATIENTS WHO HAVE THE COMBINATION MUTATIONS (NPM1+/CEBPA+)

S.A. Srour, P. Akl, S. Butt, H. Bhardwaj, T. Dunn, S. Pant, J. Holter, M.A. Cherry, OUHSC, Oklahoma City, OK; (Trainee Travel Award Recipient)

52

RESEARCH FINDINGS IN A PUBLIC CONSULTATION TO MAP THE FUTURE OF PUBLIC HEALTH GENOMICS

S.M. Modell, T. Citrin, Health Management and Policy, University of Michigan School of Public Health, Ann Arbor, MI; (Trainee Travel Award Recipient)

Geriatrics

54

EFFECTS ON IPSILATERAL LOWER LIMB MUSCLES REVEALED WITH STIMULUS TRIGGERED AVERAGING OF EMG ACTIVITY IN MACAQUE MONKEYS

W.G. Messamore, H.M. Hudson, G.M. Van Acker, H.Y. Zhang, P.D. Cheney, Physiology, University of Kansas Medical School, Kansas City, KS; (Trainee Travel Award Recipient, MWAfMR Scholars Award)

Morning Break, Lunch, Afternoon Break and Poster Session

Friday, April 27, 2012 • 9:30am – 10:30am • 11:30am – 12:30pm • 2:00pm – 3:00pm • Halstead Foyer/Avenue Ballroom

Hematology and Oncology

56

ENDOTHELIAL COLONY FORMING CELLS (ECFC) IN MULTIPLE MYELOMA

R. Sharma, A. Suvannasankha, C. Crean, Indiana University School of Medicine, Indianapolis, IN

58

EXAMINING THE SELECTIVE CONTRIBUTION OF CHROMOSOMAL INSTABILITY TO TUMOR EVOLUTION AND PROGNOSIS

S.F. Bakhoun, Norris Cotton Cancer Center, Dartmouth Medical School, Hanover, NH; O. Danilova, P. Kaur, N. Levy, Pathology, Dartmouth-Hitchcock Medical Center, Lebanon, NH; D.A. Compton, Biochemistry, Dartmouth Medical School, Hanover, NH; (Trainee Travel Award Recipient, MWAFFMR Scholars Award)

60

TARGETING HISTONE DEACETYLASES AS A NEW STRATEGY FOR GRAFT VERSUS HOST DISEASE PREVENTION

S.W. Choj, J. Ferrara, J. Levine, S. Paczesny, C. Kitko, G. Yanik, Pediatrics / Hematology Oncology, University of Michigan Medical Center, Ann Arbor, MI; K. Stockerl-Goldstein, J. DiPersio, Internal Medicine / Hematology Oncology, Washington University School of Medicine, St. Louis, MO; O. Krijanovski, Blood and Marrow Transplantation Program, Alta Bates Summit Medical Center, Berkeley, CA; T. Braun, Biostatistics, University of Michigan School of Public Health, Ann Arbor, CA; S. Mineishi, D. Couriel, J. Magenau, E. Peres, A. Pawarode, P. Reddy, Internal Medicine / Hematology Oncology, University of Michigan Medical Center, Ann Arbor, MI; M. Lehmann, Internal Medicine / Cardiology, University of Michigan Medical Center, Ann Arbor, MI; (K-Award Recipient)

62

VARIATION IN DNA METHYLATION BETWEEN AFRICAN AND EUROPEAN HAPMAP POPULATIONS REVEAL POTENTIAL EPIGENETIC CONTRIBUTION TO RACIAL DISPARITY IN CANCER RISK

E.L. Moen, S.M. Delaney, C. Wing, J. McQuade, L.A. Godley, E. Dolan, University of Chicago, Chicago, IL; W. Mu, W. Zhang, University of Illinois at Chicago, Chicago, IL

64

FACTOR V LEIDEN THE ASSOCIATION WITH RECURRENT MISCARRIAGES

G. Boriel, J. Jurantee, C. Abuchaibe, Z. Khan, P. Wang, C. Glueck, Internal Medicine, The Jewish Hospital Of Cincinnati, Cincinnati, OH; (Trainee Travel Award Recipient)

66

HYPOPLASTIC MDS WITH PNH CLONE TREATED SUCCESSFULLY WITH ECULIZUMAB

S. John, Internal Medicine, University of Oklahoma Health Sciences Center, Oklahoma City, OK; H. Parekh, O. Qubaiah, G. Selby, J. Holter, Hematology and Oncology, University of Oklahoma Health Sciences Center, Oklahoma City, OK

Infectious Disease

68

BACILLUS ANTHRACIS LETHAL TOXIN IMPAIRS ALVEOLAR EPITHELIAL BARRIER FUNCTION

M. Langer, J. Booth, E.S. Duggan, V.I. Patel, S. Awasthi, J. Metcalf, University of Oklahoma Health Sciences Center, Oklahoma City, OK; T.Z. Veres, F. Prenzler, K. Sewald, A. Braun, Fraunhofer Institute for Toxicology and Experimental Medicine, Hannover, GERMANY; F. Lupu, K. Coggeshall, Oklahoma Medical Research Foundation, Oklahoma City, OK

70

INDUCTION OF ANTIVIRAL CHEMOKINES IN MONOCYTE-DERIVED MACROPHAGES BY THE HTLV-2 TRANSACTIVATING PROTEIN, TAX2

G. Balistreri, C.S. Barrios, L. Castillo, M.A. Beilke, Infectious Disease Division, Department of Medicine, Medical College of Wisconsin, Milwaukee, WI; (Trainee Travel Award Recipient)

2012 Combined Annual Meeting of CSCR and MWAfMR

Morning Break, Lunch, Afternoon Break and Poster Session

Friday, April 27, 2012 • 9:30am – 10:30am • 11:30am – 12:30pm • 2:00pm – 3:00pm • Halstead Foyer/Avenue Ballroom

72

RECURRENCES OF C. DIFFICILE INFECTION IN SOLID ORGAN TRANSPLANT RECIPIENTS MAY BE PREVENTED BY LACTOBACILLUS TREATMENT

A. Deshpande, Infectious Diseases, Louis Stokes Cleveland Department of Veterans Affairs Medical Center, Cleveland, OH; V. Pasupuleti, Molecular Cardiology, Cleveland Clinic, Cleveland, OH; S. Mossad, S. Schmitt, S. Mawhorter, R.K. Avery, Infectious Diseases, Cleveland Clinic, Cleveland, OH; M. Budev, Pulmonary and Critical Care Medicine, Cleveland Clinic, Cleveland, OH; R. Corey, Pharmacy, Cleveland Clinic, Cleveland, OH; B. Eghtesad, Transplant Center, Cleveland Clinic, Cleveland, OH; A. Jain, Internal Medicine, Cleveland Clinic, Cleveland, OH; A.V. Hernandez, Quantitative Health Sciences, Cleveland Clinic, Cleveland, OH; (Trainee Travel Award Recipient)

74

AEROSOLIZED AMIKACIN, AN OPTION FOR TREATMENT OF MULTI-DRUG RESISTANT PNEUMONIA IN A PATIENT WITH CHRONIC KIDNEY DISEASE

N. Shahid, Internal Medicine, Goshen General Hospital, Goshen, IN; M.Z. Bawany, T. Sodeman, Internal Medicine, UTMC, Toledo, OH

Nephrology

76

ANGIOTENSIN-CONVERTING ENZYME INHIBITORS (ACEI) ARE NOT CREATED EQUAL EVIDENCE FROM A RADIATION NEPHROPATHY MODEL

E.P. Cohen, Medicine, Medical College of Wisconsin, Milwaukee, WI; B.L. Fish, J.E. Moulder, Radiation Oncology, Medical College of Wisconsin, Milwaukee, WI

78

ACUTE ANGIOTENSIN II EFFECTS ON NCC ARE DEPENDENT ON WNK4

B. Ko, L. Hansen, Medicine, The University of Chicago, Chicago, IL; A. Mistry, R. Mallick, R. Hoover, Medicine, Emory University, Atlanta, GA; (K-Award Recipient)

Pulmonary/Critical Care

80

ASSOCIATION OF BIOMARKER SPHINGOSINE-1-PHOSPHATE RECEPTOR 3 GENETIC VARIANTS WITH HUMAN SUSCEPTIBILITY TO SEPSIS-INDUCED ACUTE LUNG INJURY

X. Sun, S. Ma, P.A. Singleton, M.S. Wade, J.G. Garcia, Medicine, University of Illinois at Chicago, Chicago, IL; (Cardiovascular Award Recipient)

82

INTESTINAL EXPRESSION OF CFTR ALLEVIATES THE MECONIUM ILEUS PHENOTYPE IN CYSTIC FIBROSIS PIGS

D. Stoltz, D.K. Meyerholz, T. Rokhlina, A.A. Pezzulo, L.S. Ostedgaard, S.E. Ernst, P.S. Ludwig, L.R. Reznikov, A. Uc, P.B. McCray, J. Zabner, University of Iowa, Iowa City, IA; P.H. Karp, M.J. Welsh, Howard Hughes Medical Institute, Iowa City, IA; M. Samuel, R. Prather, Division of Animal Science, University of Missouri, Columbia, MO; (K-Award Recipient)

84

A PROMOTER POLYMORPHISM OF MYLK ASSOCIATED WITH SEVERE ASTHMA UPREGULATES SMOOTH MUSCLE MYOSIN LIGHT CHAIN KINASE ISOFORM

X. Sun, S. Ma, Y.J. Han, M.S. Wade, J.G. Garcia, Medicine, University of Illinois at Chicago, Chicago, IL

86

LYSCARDIOLIPIN ACYLTRANSFERASE (LYCAT) PROTECTS BLEOMYCIN-INDUCED LUNG INFLAMMATION AND FIBROSIS IN MICE

L. Huang, P. Fu, W. Ma, D. He, V. Natarajan, Pharmacology, B. Mathew, T. Zhou, J. Garcia, Medicine, W. Zhang, S. Reddy, Pediatrics, University of Illinois at Chicago, Chicago, IL; (Trainee Travel Award Recipient)

Morning Break, Lunch, Afternoon Break and Poster Session

Friday, April 27, 2012 • 9:30am – 10:30am • 11:30am – 12:30pm • 2:00pm – 3:00pm • Halstead Foyer/Avenue Ballroom

90

RAC1 MITOCHONDRIAL IMPORT AND MITOCHONDRIAL H₂O₂ GENERATION IS MODULATED BY GERANYLGERANYLATION OF THE CYSTEINE-189 RESIDUE

H.L. Osborn-Heaford, S. Murthy, A.J. Ryan, B. Carter, Internal Medicine / Pulmonary and Critical Care, University of Iowa Hospitals and Clinics, Iowa City, IA

92

CORTACTIN REGULATES PULMONARY ENDOTHELIAL CYTOSKELETAL STRUCTURE AND MEMBRANE DYNAMICS

P. Belvitch, M.E. Brown, C.M. Sara, J. Siegler, D. Adyshev, J.G. Garcia, S.M. Dudek, Pulmonary, Critical Care, Sleep and Allergy, University of Illinois, Chicago, IL; (Trainee Travel Award Recipient)

94

FTY720 S-PHOSPHONATE ENHANCES ENDOTHELIAL BARRIER FUNCTION VIA CYTOSKELETAL REARRANGEMENT AND PROTECTS AGAINST BLEOMYCIN-INDUCED ACUTE LUNG INJURY IN MICE

L. Wang, S. Sammani, L. Moreno-Vinasco, E. Letsiou, T. Wang, S. Camp, J. Garcia, S. Dudek, Department of Medicine, University of Illinois at Chicago, Chicago, IL; R. Bittman, Queens College of The City University of New York, Flushing, NY; (Trainee Travel Award Recipient)

96

IL-33 INDUCES ITS RECEPTOR ST2L DEGRADATION THROUGH ACTIVATION OF GLYCOGEN SYNTHASE KINASE 3

J. Zhao, R.K. Mialki, J. Wei, L. Wallace, D. Mallampalli, B.B. Chen, T. Coon, C. Zou, R. Mallampalli, Y. Zhao, Department of Medicine, University of Pittsburgh, Pittsburgh, PA; (Trainee Travel Award Recipient, MWAFMR Scholars Award)

98

MITOTEMPOL TREATMENT TO TARGET MITOCHONDRIAL OXIDATIVE DAMAGE IN AN EXPERIMENTAL MODEL OF ASTHMA

O.A. Jaffer, P. Sanders, M. Anderson, I. Grumbach, Internal Medicine, University of Iowa, Iowa City, IA; (Trainee Travel Award Recipient)

100

DIFFERENTIAL ROLE OF EZRIN/RADIXIN/MOESIN PROTEINS IN REGULATION OF ENDOTHELIAL HYPER PERMEABILITY AFTER THROMBIN

D. Adyshev, N. Moldobaeva, S.M. Dudek, J.G. Garcia, Institute for Personalized Respiratory Medicine, The University of Illinois at Chicago, Chicago, IL; A. Verin, Vascular Biology Center, Georgia Health Sciences University, Augusta, GA

Rheumatology/Immunology/Allergy

102

BASELINE SERUM INTERFERON ALPHA/BETA RATIO PREDICTS RESPONSE TO TUMOR NECROSIS FACTOR ALPHA INHIBITION IN RHEUMATOID ARTHRITIS

R. Aggrawal, B.S. Franek, T.B. Niewold, Section of Rheumatology and Gwen Knapp Center for Lupus Research, University of Chicago, Chicago, IL; M. Kern, P.K. Gregersen, Center for Genomics and Human Genetics, Feinstein Institute Medical Research, North Shore LIJ Health System, Manhasset, NY; (K-Award Recipient)

104

RHABDOMYOLYSIS A LESS KNOWN SIDE EFFECT OF A WELL KNOWN DRUG

N. Shahid, Internal Medicine, Goshen General Hospital, Goshen, IN; M.Z. Bawany, T. Sodeman, Internal Medicine, University of Toledo Medical Center, Toledo, OH

2012 Combined Annual Meeting of CSCR and MWAfMR

2012 Combined Annual Meeting Award Winners

Oral Abstract Award Recipients

John Giudicessi, MD, PhD Candidate, *Mayo Clinic*
Hatim Hassan, MD, PhD, *The University of Chicago*
Vijay Shivaswamy, MBBS, *Omaha VA Medical Center*
Nathaniel Watson, MD, *University of Washington*

Outstanding Young Investigator Award Recipient

Yutong Zhao, MD, PhD, *University of Pittsburgh*

Featured New Investigator Award Recipient

R. Stephanie Huang, PhD, *University of Chicago*

Cardiovascular Award Recipient

Xiaoguang Sun, MD, PhD, *University of Illinois at Chicago*
All of above award recipients will present their abstracts on Friday afternoon, April 27th.

K Award Recipients

(Each recipient receives a \$1000 award)

Blanca Camoretti-Mercado, PhD, *University of Chicago*
Sung Choi, MD, *University of Michigan*
Dawn Davis, MD, PhD, *University of Wisconsin*
Apar Kishor Ganti, MD, MS, FACP, *VA Nebraska Western Iowa Health Care System*
Gene Ho Kim, MD, *University of Chicago*
Benjamin Ko, MD, *University of Chicago*
Suthat Liangpunsakul, MD, MPH, *Indiana University School of Medicine*
Christopher Masi, MD, *NorthShore University HealthSystem*
Timothy Niewold, MD, *University of Chicago*
Robert Sargis, MD, PhD, *University of Chicago*
David Stoltz, MD, PhD, *University of Iowa Carver College of Medicine*

Trainee Travel Award Recipients

(Recipients residing in IL receive a \$300 award. Recipients residing outside of IL receive a \$600 award)

Cesar Abuchaibe, MD, *The Jewish Hospital - Cincinnati*
Djanybek Adyshev, PhD, *The University of Illinois at Chicago*
Mathieu Bakhom, MD, PhD student, *The University of Texas Medical Branch*
Samuel Bakhom, PhD, *Dartmouth Medical School*
Glorilee Balistrieri, MD student, *Medical College of Wisconsin*

Patrick Belvitch, MD, *University of Illinois*
Gail Boriel, MD, *The Jewish Hospital - Cincinnati*
Lindsay Bromley, MD, *University of Chicago*
Jiwang Chen, PhD, *University of Illinois at Chicago*
Weiguo Chen, MD, PhD, *University of Illinois at Chicago*
Abhishek Deshpande, MD, PhD, *Case Western Reserve University*
Colleen Flynn, *University of Chicago*
Panfeng Fu, *University of Illinois at Chicago*
Jason Gill, MD/PhD Candidate, *University of Kansas Medical Center*
Caleb Grote, BS, *University of Kansas Medical Center*
Matthew Hirschey, PhD, *Duke University*
Longshuang Huang, PhD, *University of Illinois at Chicago*
Giovanni Infusino, MD, *University of Illinois at Chicago*
Shuxia Jiang, MD, *University of Iowa Hospitals and Clinics*
Joel Jurantee, MD, *The Jewish Hospital - Cincinnati*
Naseer Khan, MD, *The Jewish Hospital - Cincinnati*
David Knorr, MD PhD student, *University of Minnesota*
Anoopa Koshy, MD, *University of Chicago Medical Center*
Eleftheria Letsiou, PhD, *University of Illinois at Chicago*
Prescott Mackie, MS, *University of Iowa Hospitals and Clinics*
William Messamore, MD PhD student, *University of Kansas Medical School*
Stephen Modell, MD, MS, *University of Michigan School of Public Health*
Jingnesh Modi, *Southern Illinois University School of Medicine*
Wenbo Mu, BS, *University of Illinois at Chicago*
Evan Noch, PhD, *Temple University School of Medicine*
Jason Rizzo, *SUNY Buffalo*
Lokesh Shahani, MD, MPH, *Southern Illinois University School of Medicine*
Ali Sovari, MD, *University of Illinois at Chicago*
Samer Srour, MB ChB, *The University of Oklahoma Health Sciences Center*
Rafeel Syed, *The Jewish Hospital - Cincinnati*
Mohammad Uddin, PhD, *Texas A & M University Health Science Center College of Medicine*
Jeannie Visootsak, MD, *Emory University*
Lichun Wang, PhD, *University of Illinois at Chicago*
Wai Chong Wong, BS, *Rosalind Franklin University of Medicine and Science*
Lishi Xie, *University of Illinois at Chicago*
Jing Zhao, MD, PhD, *University of Pittsburgh*
Yutong Zhao, MD, PhD, *University of Pittsburgh*
Tingting Zhou, MD, *University of Illinois at Chicago*

Society Officers and Directors

Central Society for Clinical Research

President

Virginia Savin, MD
Kansas City, KS

Past President

Bradley Britigan, MD
Omaha, NE

President-Elect

Neal Weintraub, MD
Cincinnati, OH

Secretary-Treasurer

Terry Unterman, MD
Chicago, IL

Vice President

Jordan Metcalf, MD
Oklahoma City, OK

Editor

Jeffrey Laurence, MD
New York, NY

Councilors

Mark Anderson, MD, PhD
Iowa City, IA

A. Brent Carter
Iowa City, IA

Ellen McCarthy, MD
Kansas City, KS

Roy Weiss, MD, MPH
Chicago, IL

Midwestern Section American Federation for Medical Research

Chair

Abraham Thomas, MD, MPH
Detroit, MI

Past Chair

James Maloney, MD
Denver, CO

Secretary-Treasurer

Kieren Mather, MD
Indianapolis, IN

Councilors

Carmella Evans-Molina, MD, PhD
Indianapolis, IN

Florence Rothenberg, MS, MD
Cincinnati, OH

Mark A. Wiley, MD
Kansas City, MO

Suthat Liangpunsakul, MD, MPH
Indianapolis, IN

2012 Combined Annual Meeting of CSCR and MWAfMR

Abstract Reviewers

Mark Anderson, MD, PhD
Bradley Britigan, MD
Alejandro Comellas, MD
William Dale, MD, PhD
Carmella Evans-Molina, MD, PhD
Siri Greeley, MD, PhD
Isabella Grumbach, MD
Tamara Hannon, MD
Jeffrey Laurence, MD
Kieren Mather, MD
Ellen McCarthy, MD

Jordan Metcalf, MD
Steven Moberly, MD PhD Student
Steven Pipe, MD
Jill Poole, MD
Florence Rothenberg, MS, MD
Robert Sargis, MD, PhD
Virginia Savin, MD
Vijay Shivaswamy, MBBS
David Stoltz, MD, PhD
Abraham Thomas, MD, MPH
Terry Unterman, MD
Mark Wiley, MD



About our Featured Presenters

MWAFMR Career Development Workshop



Scott C. Litin, MD

Editor-in-chief of the third and fourth editions of the "Mayo Clinic Family Health Book," Dr. Scott Litin is a practicing general internist at Mayo Clinic, Rochester, Minn., and a professor at Mayo Clinic College of Medicine.

A distinguished practitioner, lecturer and teacher, Dr. Litin has served in numerous leadership positions at Mayo Clinic and nationally. He's a recipient of many awards, including the prestigious Henry S. Plummer Distinguished Physician Award and the Distinguished Clinician Award from Mayo Clinic. The American College of Physicians has recognized him as a Master of the College.



Laurie R. Weingart, PhD

Dr. Weingart is the Carnegie Bosch Professor of Organizational Behavior and Theory at the David A. Tepper School of Business, Carnegie Mellon University. She earned her PhD in Organizational Behavior from the Kellogg School of Management at Northwestern University. Professor Weingart's research and teaching is in the areas of negotiation, conflict, and teams. Professor Weingart has served as the President of the International Association for Conflict Management and the Interdisciplinary Network for Group Research.

of Management at Northwestern University. Professor Weingart's research and teaching is in the areas of negotiation, conflict, and teams. Professor Weingart has served as the President of the International Association for Conflict Management and the Interdisciplinary Network for Group Research.

Max Miller Lecture



David Mangelsdorf, PhD

David Mangelsdorf received his PhD in Biochemistry from the University of Arizona and completed his postdoctoral studies and The Salk Institute for Biological Studies. Since 1993 he has been at the University of Texas Southwestern

Medical Center at Dallas, where he currently is Professor and Chair of the Department of Pharmacology, and an Investigator of the Howard Hughes Medical Institute, he holds the Raymond and Ellen Willie Distinguished Chair in Molecular Neuropharmacology, and he is a member of the National Academy of Sciences.

The Role of Inflammation in Health and Disease



Peter Libby, MD

Dr. Libby is the Chief of Cardiovascular Medicine at Brigham and Women's Hospital in Boston, MA. He also serves as the Mallinckrodt Professor of Medicine at Harvard Medical School. His current major research focus is the roll of inflammation

in vascular diseases such as atherosclerosis. Dr. Libby has received numerous awards and recognitions for his research accomplishments, most recently the Gold Medal of the European Society of Cardiology (2011) and the Basic Research Prize of the American Heart Association (2011). His areas of clinical expertise include general and preventive cardiology.



Melissa Brown, PhD

Dr. Brown received her undergraduate degree in biology at the University of Tennessee and earned her PhD degree at the University of Washington, where she studied the genetic basis of immune responses to retroviruses. As a post-doctoral

fellow with Dr. William Paul at the Laboratory of Immunology at NIH, she began her studies on mast cells, with a focus on understanding the mechanisms that regulate IL4 expression. These studies have continued and expanded to include investigation of the functions of mast cells in autoimmune disease and infection. Since her post-doctoral fellowship, she has served on the faculty of the Oregon Health Sciences University and Emory University. She joined the faculty of Northwestern University in 2003.



Thomas Gajewski, MD, PhD

Dr. Gajewski investigates and develops new treatments for patients with melanoma. He has a special interest in the development of immunotherapies against this disease. Dr. Gajewski also leads development of immune-

based therapies for other cancers, using new laboratory data on how the immune system is regulated to develop novel clinical trials. Dr. Gajewski serves as an editor for Cancer Research. In addition, he is president of the Society for Immunotherapy of Cancer and has served on the program committees for the American Society for Clinical Oncology (ASCO) and the American Association for Cancer Research (AACR).



G.R. Scott Budinger, MD

Dr. Budinger is an Associate Professor in Medicine-Pulmonary and Cell and Molecular Biology at Northwestern University Feinberg School of Medicine. Dr. Buginger's professional interests include asthma; pulmonary fibrosis and sarcoidosis.

About our Featured Presenters

MWAfMR Keynote



Nancy Brown, MD

Dr. Brown, a specialist in vascular biology and hypertension, earned her BA degree in Molecular Biophysics and Biochemistry from Yale University and her MD with honors from Harvard University. She completed her medical and clinical pharmacology training at Vanderbilt, where she was the Hugh J. Morgan Chief Resident in 1992, then joined the faculty that same year. She was named chief of Clinical Pharmacology at Vanderbilt in January 2009 and Chair of the Department of Medicine in August of 2010.

CSCR Hickam Lecturer



Arthur H. Rubenstein, MBCh

Dr. Rubenstein currently serves as Professor, Department of Medicine, Division of Endocrinology at the Raymond and Ruth Perelman School of Medicine at the University of Pennsylvania. Dr. Rubenstein is an internationally-prominent endocrinologist recognized for clinical expertise and groundbreaking research in diabetes. Well-known for his inspired teaching, Dr. Rubenstein has served in numerous professional leadership positions during his career. Before joining Penn, Dr. Rubenstein served for four years as Dean of Mount Sinai School of Medicine and Gustave L. Levy Distinguished Professor. Earlier, he was the Lowell T. Coggeshall Distinguished Service Professor of Medical Sciences and Chairman of the Department of Medicine at the University.

Department Chair Session I—Medical College of Wisconsin (MCW)

Joshua Field, MD, MS

Dr. Field is an Associate Investigator at the Blood Center of Wisconsin and an Assistant Professor of Medicine at MCW. He attended medical school at the University of Iowa and completed a residence in General Medicine and Fellowship in Hematology and Transfusion Medicine at Washington University in St. Louis, MO, where he was also a chief fellow.

Jennifer Strand, MD, PhD

Dr. Strand is an assistant professor in the Division of Cardiovascular Medicine at MCW. In addition to her clinical duties, she engages in basic and translational research in which she investigates the pathological mechanisms of heart failure. She has received a Future Leader in Cardiovascular Medicine Research Award and has been a two-time finalist in the Northwestern Cardiovascular Young Investigators Forum.

Michael Widlansky, MD, MPH

Dr. Widlansky is an Assistant Professor in the Department of Medicine at MCW. He earned his Bachelor's Degree in Chemistry from Stanford University and his MD from the University of Michigan. He completed his internal medicine training at Brigham and Women's Hospital and his cardiology fellowship at Boston University. His research interests include the mechanisms of vascular dysfunction in type 2 diabetes and the effect of physical activity on human endothelial function. Dr. Widlansky currently holds a K23 and an AHA grant-in-aid related to these topics.

Department Chair Session II—University of Chicago Medical Center

Vineet Arora, MD, MAPP

As a hospitalist-researcher, Dr. Arora's academic work focuses on resident duty hours, patient handoffs, and quality and safety of hospital care. Through an NIA K23 career development award, she is currently completing a study of sleep and physical function in hospitalized older patients using objective measures. Through a variety of funding from AHRQ and the ABIM Foundation, she has evaluated various interventions to improve physician-physician communication in the hospital. Dr. Arora's ongoing quality and safety research related to hospitalized patients in teaching hospitals has been published in numerous peer reviewed publications and has received media coverage by the New York Times, CNN, ABC News and US News and World Report.

Michael Maitland, MD, PhD

Michael Maitland is a physician-scientist who conducts research in cancer therapeutics. His clinical expertise is in the care of patients with lung cancer, treatment of patients with advanced solid tumors who receive investigational therapy, as well as clinical pharmacology and pharmacogenetics. His research team has focused on the development of new biomarkers that might accelerate and improve cancer drug development. He is an Assistant Professor of Medicine in the Section of Hematology/Oncology and Committee on Clinical Pharmacology and Pharmacogenomics at the University of Chicago.

About our Featured Presenters

Robert Sargis, MD, PhD

Dr. Sargis is an endocrinology fellow at the University of Chicago. He completed his undergraduate education at Carleton College in Northfield, MN, before earning his medical degree at Rush University Medical College in Chicago. He also earned his PhD from the Graduate College at Rush University. In his current postdoctoral research, Dr. Sargis is investigating how environmental pollutants relate to the development of obesity and diabetes by altering endocrine systems.

Featured New Investigator

R. Stephanie Huang, PhD

Dr. Huang received her PhD in Clinical Pharmacy from Purdue University. She continued her post-doctoral Fellowship training in Clinical Pharmacology at the University of Chicago. Dr. Huang currently an Assistant Professor of Medicine at the University of Chicago; Director, the Pharmacogenomics of Anticancer Agents Research (PAAR) Cell Line Core; Member, Committee on Clinical Pharmacology and Pharmacogenomics, the University of Chicago Comprehensive Cancer Center, Center for Personalized Therapeutics, Committee on Cancer Biology and Faculty Oversight Committee for Pharmacology Core facility. Dr. Huang has more than 30 original research publications, many of which in high impact journals including Nature Medicine, PNAS, American Journal of Human Genetics, Blood, PLoS Genetics and Cancer Research.

Cardiovascular Award Recipient

Xiaoguang Sun, MD, PhD

Dr. Sun received his MD degree from Shandong University School of Medicine and his PhD from Beijing Medical University. He is currently a Fellow at the University of Chicago where his research focuses primarily on G-protein related receptors in cardiovascular and pulmonary diseases by genetic, molecular biology and physiology. Dr. Sun's research interests cover systemic hypertension, drug tolerance, and complex lung disorders such as asthma and acute lung injury (ALI/ARDS).

Outstanding Young Investigator Award Recipient

Yutong Zhao, MD, PhD

Dr. Zhao received his MD from Dalian Medical University, China and PhD in Biochemistry from Gifu Medical University, Japan. He completed his post-doctoral fellow training in molecular biology at University of Delaware and in pulmonary diseases at Johns Hopkins University School of Medicine, and became a junior faculty in Department of Medicine at Johns Hopkins University. Following with Drs. Joe Garcia and V. Natarajan, Dr. Zhao moved to University of Chicago and was promoted to Assistant Professor (RA) in Division of Pulmonary and Critical

Care. In March 2010, Dr. Zhao joined the Pulmonary, Allergy, and Critical Care faculty at the University of Pittsburgh as an Associate Professor. Dr. Zhao's laboratory focuses on role of lysophospholipids in pulmonary epithelial and endothelial inflammation and remodeling.

Oral Abstract Presenters

John Giudicessi, MD, PhD Candidate

John Giudicessi is a sixth year MD/PhD student at the Mayo Graduate and Medical Schools, Mayo Clinic, Rochester, MN. After receiving his bachelor's degree with high distinction from Lawrence University, Appleton, WI, he entered the Medical Scientist Training Program at the Mayo Clinic in and is nearing the completion of his PhD thesis research in the Windland Smith Rice Sudden Death Genomics Laboratory of Dr. Michael J. Ackerman.

Hatim A. Hassan, MD, PhD

Dr. Hassan's research focuses on regulation of SLC26A6, an anion exchanger which plays an essential role in intestinal oxalate secretion and thereby in the prevention of hyperoxaluria and calcium oxalate kidney stone disease. We previously found that PKC-delta activation negatively regulates SLC26A6 activity by reducing its surface expression. His lab is currently studying the roles of cholinergic, purinergic, and serotonergic signaling, acting through PKC-delta, in the regulation of intestinal oxalate transport and how these signaling pathways might pertain to the risk of hyperoxaluria and calcium oxalate kidney stone disease.

Vijay Shivaswamy, MBBS, MS

Dr. Shivaswamy is a board certified clinical endocrinologist, involved in basic and clinical research at the University of Nebraska Medical Center and Veterans Affairs Medical Center in Omaha. His current research interests include mechanisms and preventions of immune-suppressant induced hyperglycemia/hyperinsulinemia, prevention of post-transplant diabetes after kidney transplantation and reproductive function after kidney/pancreas transplantation. Dr. Shivaswamy is also working as a PI/co-investigator in various multi-site clinical trials funded by NIH and pharmaceutical companies.

Nathaniel Watson, MD, MSc

Dr. Watson is the Co-director of the University of Washington Medicine Sleep Center and a member of the American Academy of Sleep Medicine Board of Directors. He is current President of the American Board of Sleep Medicine. He works with the University of Washington Twin Registry to assess the impact of short sleep on metabolic, inflammatory and genomic endpoints.

SAVE THE DATE

Combined Annual Meeting of CSCR and MWAFMR



April 25-26, 2013 • Renaissance Blackstone Chicago

CHICAGO 2013



CHICAGO

Central Society for Clinical Research • 555 East Wells Street, Suite 1100 • Milwaukee, WI 53202
Phone: 414.273.2209 • Fax: 414.276.3349 • E-mail: cscr@execinc.com • Web: www.cscr.com